

# Activity Centres Assembly Instructions

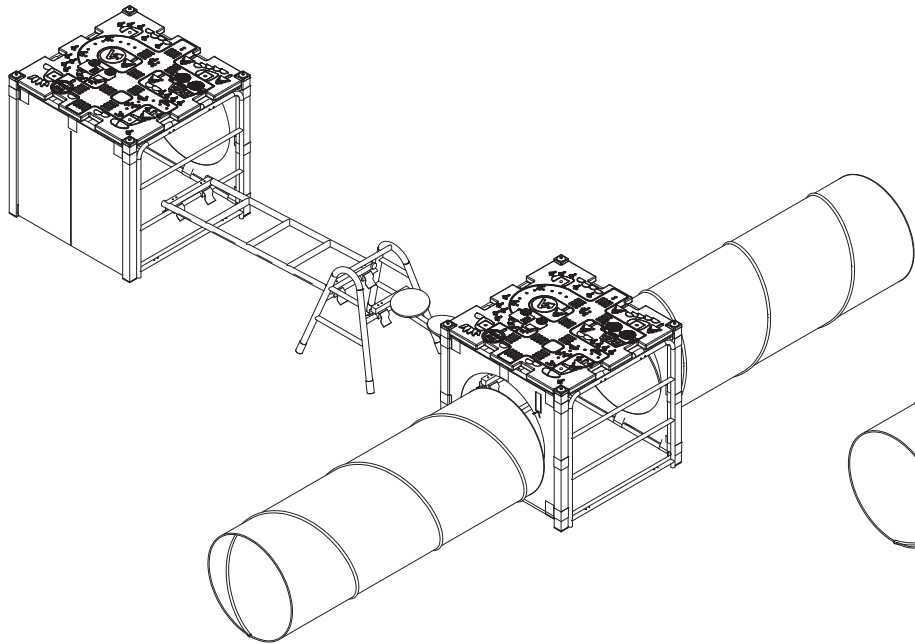

**Item Code: AJZH1A03**

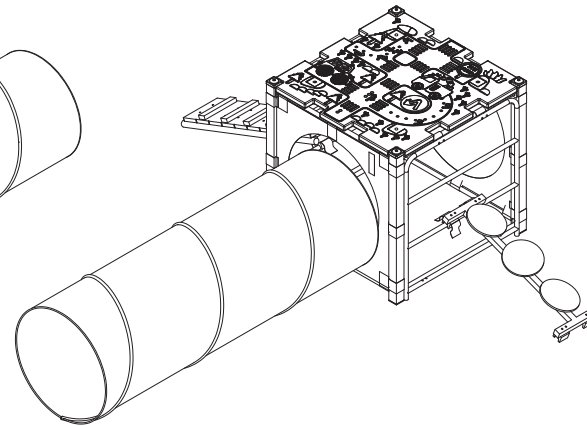

**Item Code: AJZH1A04**

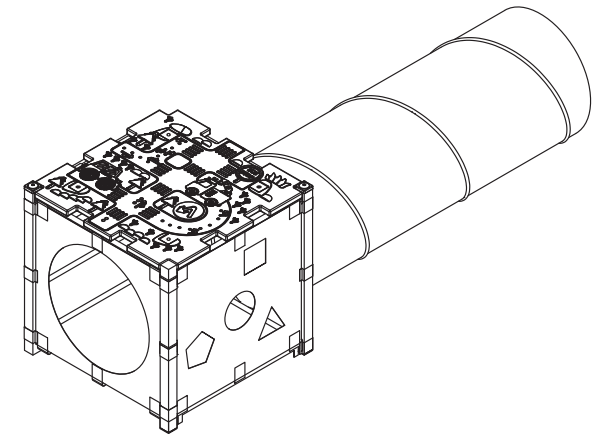

**Item Code: AJZH1A05**

Manufacturer: Wisdom Educational Product Co.,Ltd  
Manufacturer Address: Building 4, Lane 2777, Baoan Road, Malu Town, Jiading District, Shanghai, China  
Test standard: EN 1176-1:2017

# Activity Centres

## Assembly Instructions

### INSTRUCTIONS

1. Please read the instructions and warning labels carefully before use.
2. A minimum of two adults are required for assembly.
3. The product and materials are intended for indoor or outdoor use under supervised conditions.
4. Check the quantity of parts based on parts list before assembly.
5. When installing, ensure ground is either a soft fall surface, or protected by a soft material such as cardboard or a blanket when assembling to avoid frame scratching.
6. Tighten all bolts after assembly.
7. Removal all assembly materials and tools from the play area before the equipment is used.
8. During the process of incomplete installation, disassembly, or maintenance, the children should stay away from the product to ensure safety.
9. Inspect items and play area for any potential hazards prior to use.
10. Maximum number of people using the equipment at the same time is 5.
11. User age group: 2-12 years old.
12. Never leave children unattended.
13. Ensure constant adult supervision.
14. Please pay attention to the safety of the surrounding environment before use and avoid use under bad weather conditions.
15. The critical falling height is 0.9m (this is the maximum platform height), and the ground should be covered by protective surfacing materials. The materials should meet the corresponding safety standard EN1177, and the size should not be smaller than the use zone of the product.
16. If the material is damaged and needs to be repaired, please contact the manufacture to repair or replace.

### INSTALLATION METHODS

**Please ensure that the installation ground is horizontal during installation and keep it horizontal during use.**

**Method 1:** Sand layer, required size in 0.25-2mm, overall depth is not less than 22CM, monthly check to prevent the loss and potential risk.

**Method 2:** Wood mulch layer, required size in 20-80mm, overall depth is not less than 22CM, monthly check to prevent the loss and potential risk.

**Method 3:** Wood chip layer, required size in 5-30mm, overall depth is not less than 22CM, monthly check to prevent the loss and potential risk.

**Method 4:** Pea Gravel layer, required size in 2-8mm, overall depth is not less than 22CM, monthly check to prevent the loss and potential risk.

**Method 5:** Falling Mat, meet the corresponding safety requirements of EN1177.

### MAINTENANCE

1. Clean with a moist cloth.
2. Use neutral cleaners for cleaning.
3. Regularly inspect the product.
4. Follow the below inspection cycle to adequately inspect the product.
5. Fill in the inspection record after the inspection.
6. Treated pine is designed for outdoor use, this item has been pre-treated with an environmentally friendly preservative which deeply penetrates the wood.
7. A further 2 layers of wood wax oil (also environmentally friendly) are also added for further protection.
8. For maximum product life we would advise to retreat with a further coat of wood wax oil each year.

# Activity Centres - Item Code: AJZH1A03

**FRONT**

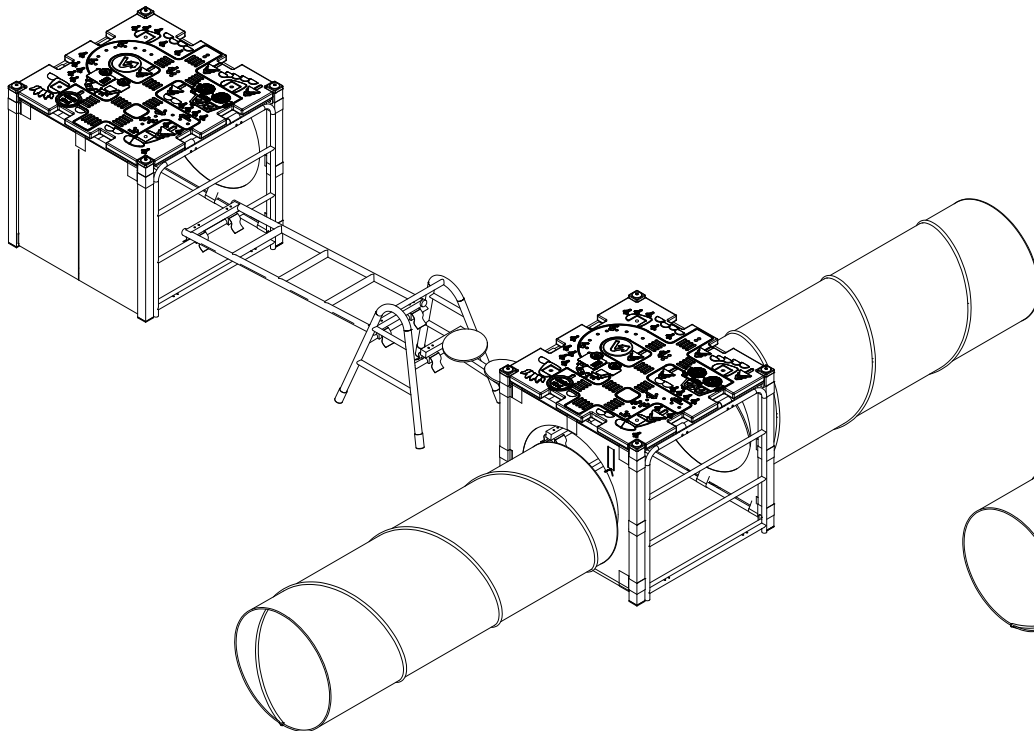

**BACK**

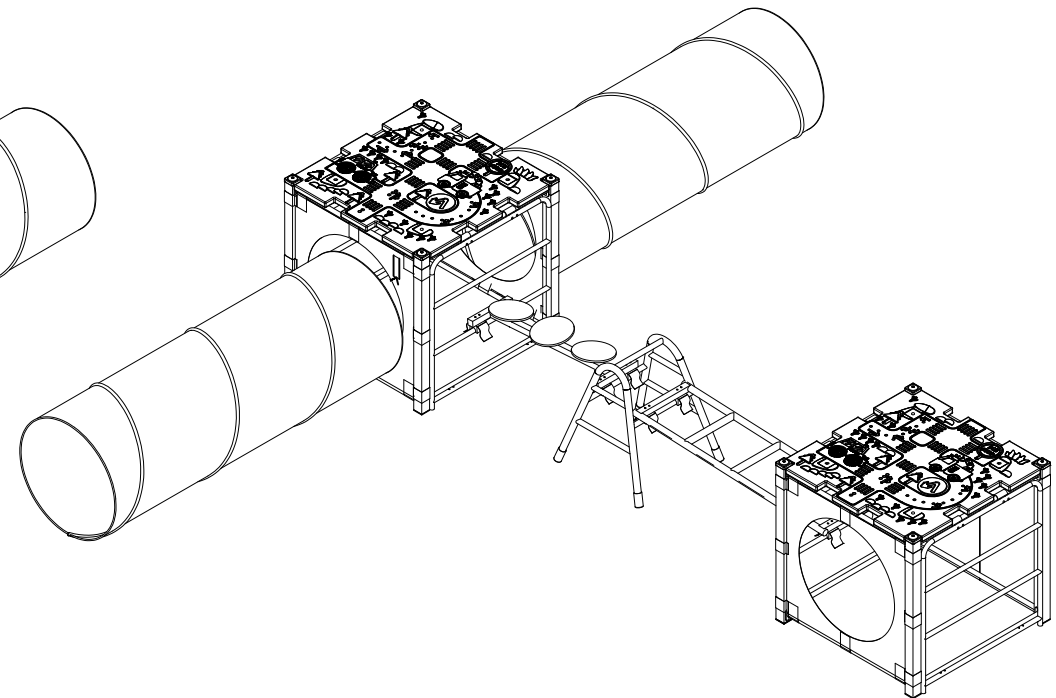

**Overall Dimensions: 444.8x396.9x84.4cm**  
**NW: 52.8KG**  
**GW: 61.5KG**

**Max component is Cube Frame**  
**Cube Frame dimensions: 86x86x84.4cm**  
**Cube Frame weight: 7KG**

# Activity Centres - Item Code: AJZH1A03

## Safety Range

Ensure the area is safe and devoid of any hazards prior to assembly.

Safety range of product: 7448x6969mm.

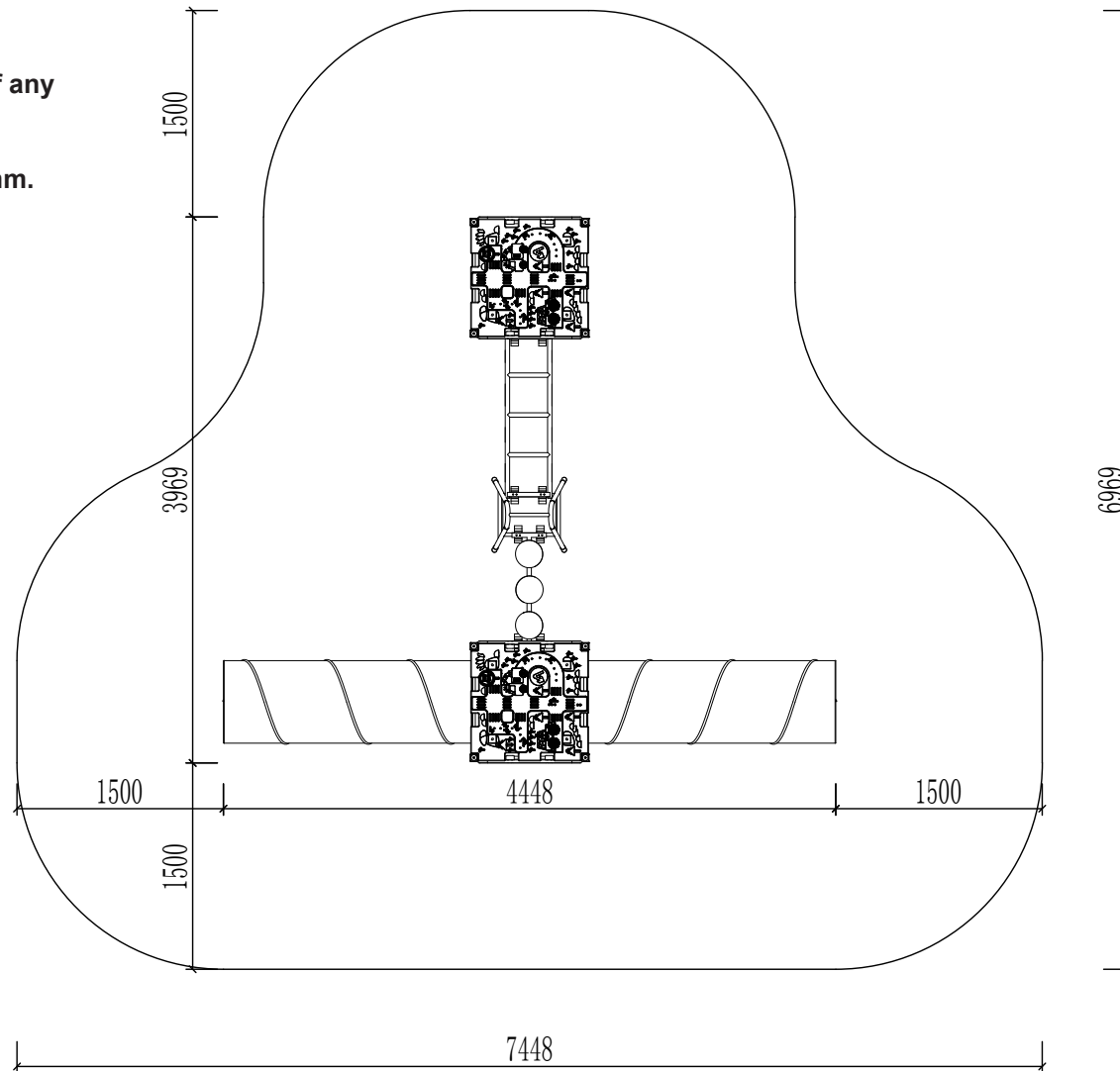

# Activity Centres - Item Code: AJZH1A03

## Part List

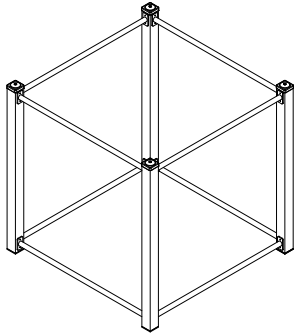

AJ1A2201-B\*2

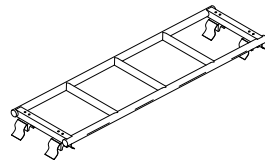

YJ001310-V01\*1

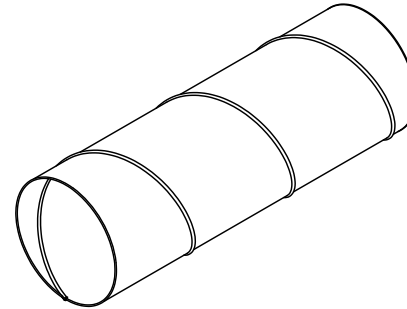

CW7-3YD2019\*2

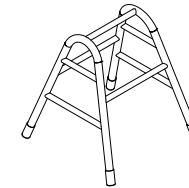

YJ001313-V02-B\*1

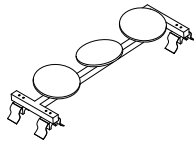

YJ001305-V01\*1

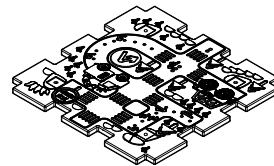

AJ1A2201-QB01-10-B\*2

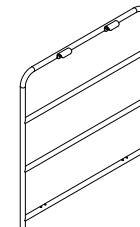

AJ1A2201-QB06\*4

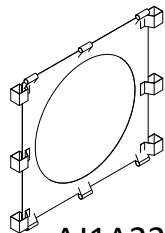

AJ1A2201-QB03\*3

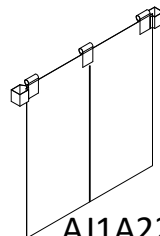

AJ1A2201-QB03\*1

# Activity Centres - Item Code: AJZH1A03

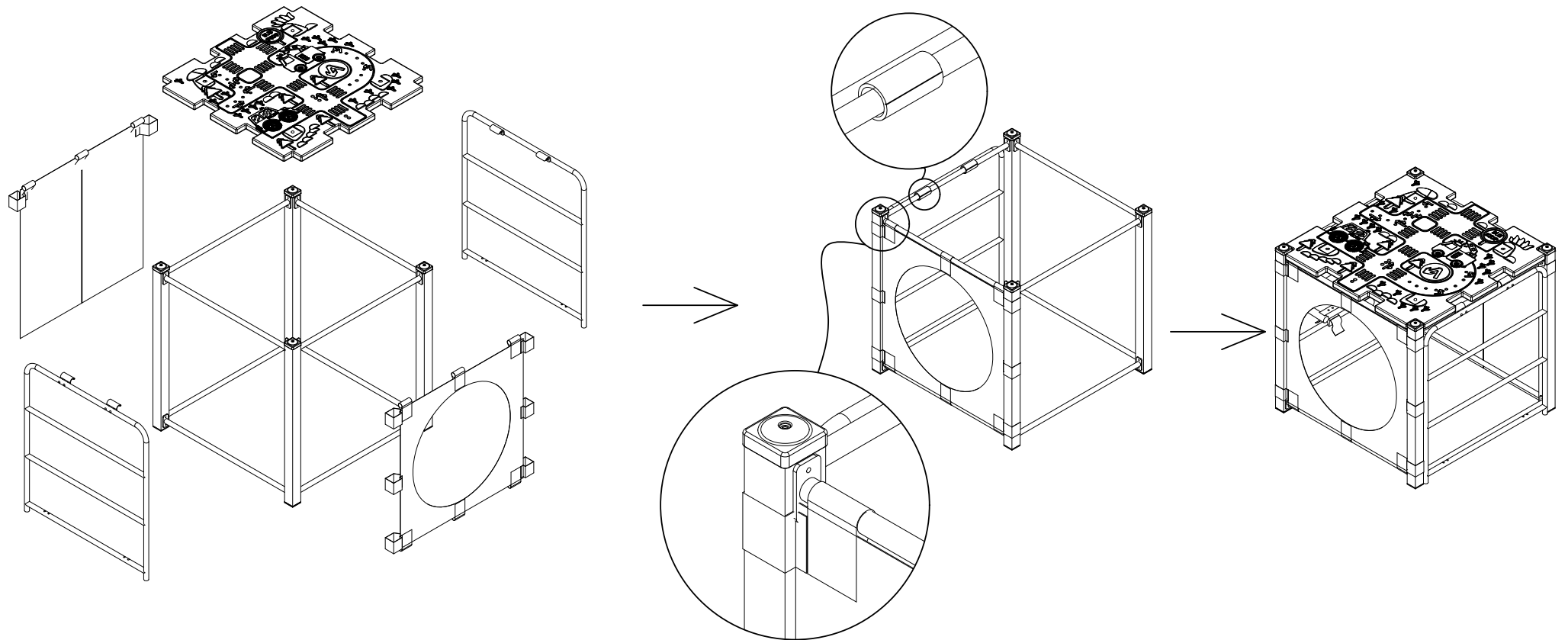

# Activity Centres - Item Code: AJZH1A03

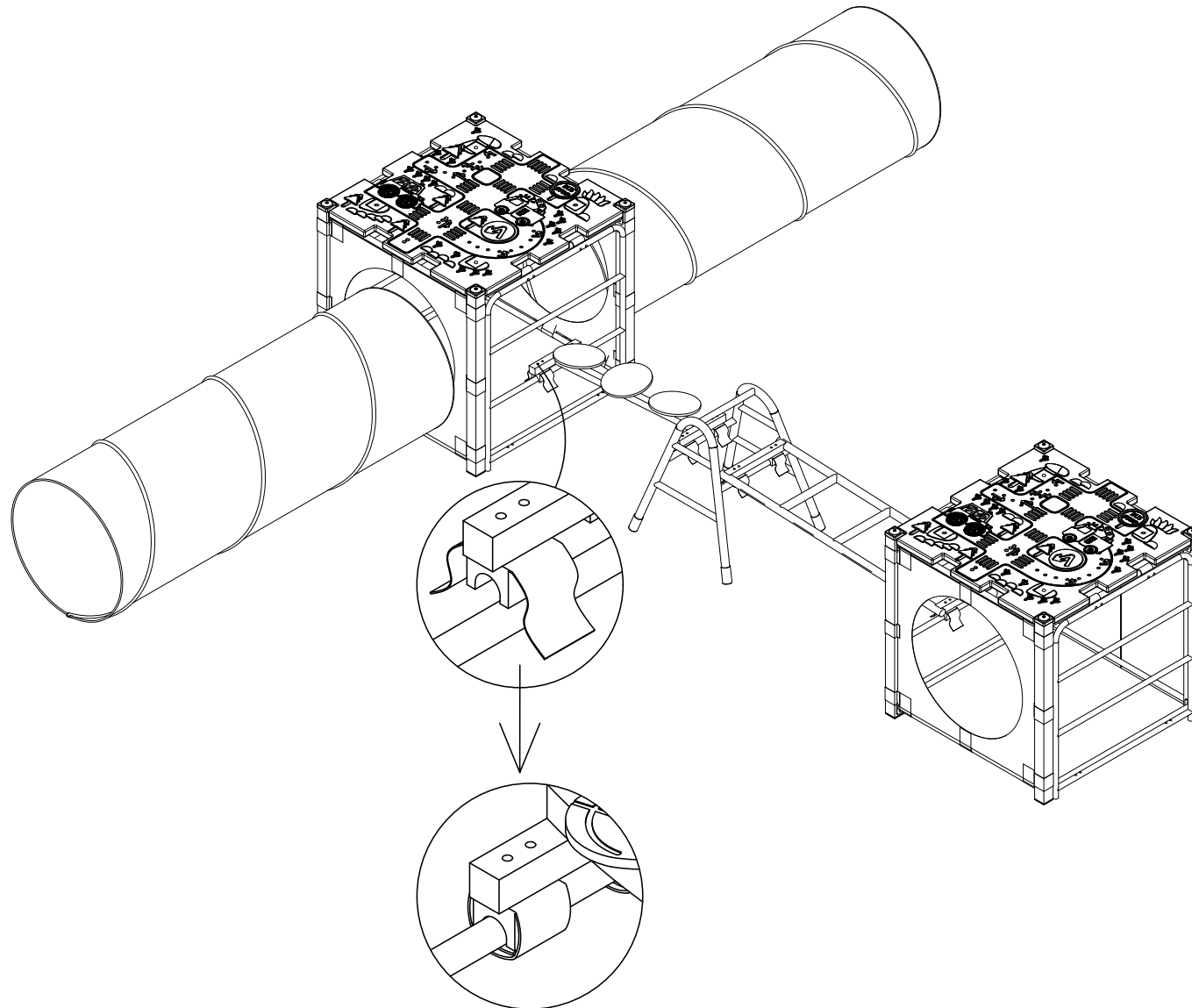

## Activity Centres - Item Code: AJZH1A03

INSPECTION INFORMATION				
Inspection cycle	Inspection Project	YES/NO	Solution	Signature
<b>Daily Inspection on Items</b>	Check screws, bolts and fasteners are tightened.			
	Installed on a flat surface and no hazards are present.			
	Equipment is free of dirt and moisture.			
	Hook and loop attachments are securely fastened.			
	Check for a signs of damage and wear.			
<b>Monthly Inspection on Items (Except for Daily Inspection on Items)</b>	Check screws are free of rust and damage.			
	Check parts are securely connected.			
	Check compliance labels are intact.			
	Check if the protective surfacing meet safety standards			
<b>Annual Inspection on Items (Except for Daily and Monthly Inspection on Items)</b>	Check there is no extensive corrosion and replace if required.			
	Check for cracking or connecting part deterioration. Replace if required.			
	Check there is no excessive discolouration of components.			
	Check screws and connectors are in working order and not damaged or deteriorated.			
	Check compliance labels are legible.			
	Check the play area under the equipment is safe and level.			



# Activity Centres - Item Code: AJZH1A04

**FRONT**

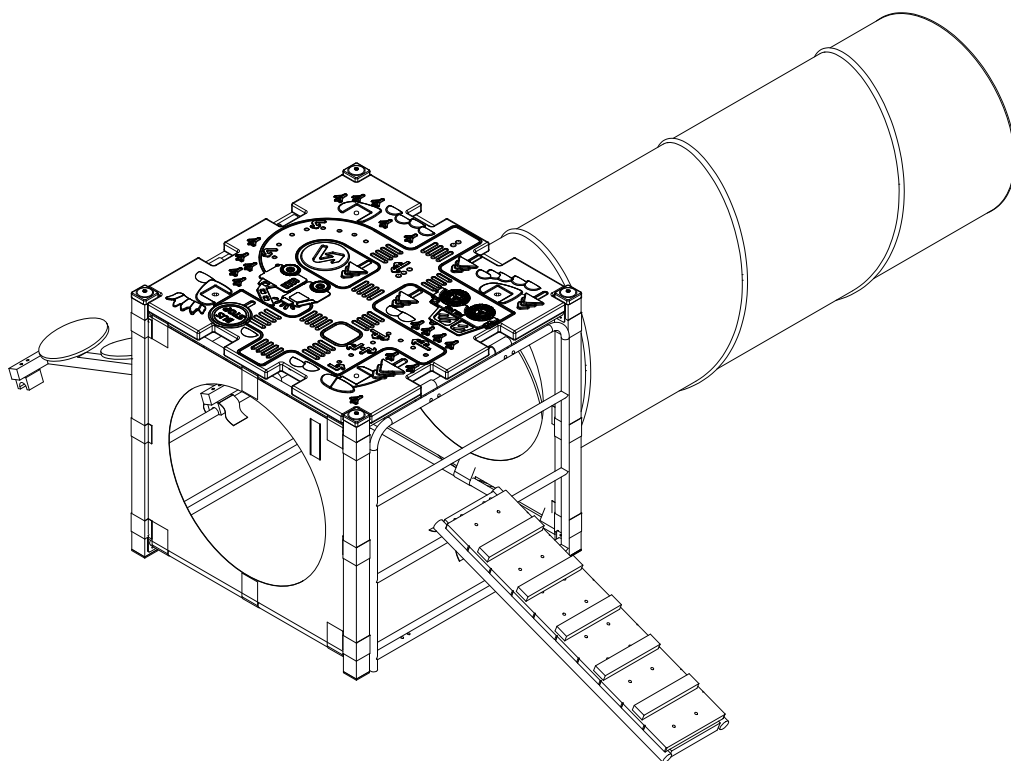

**BACK**

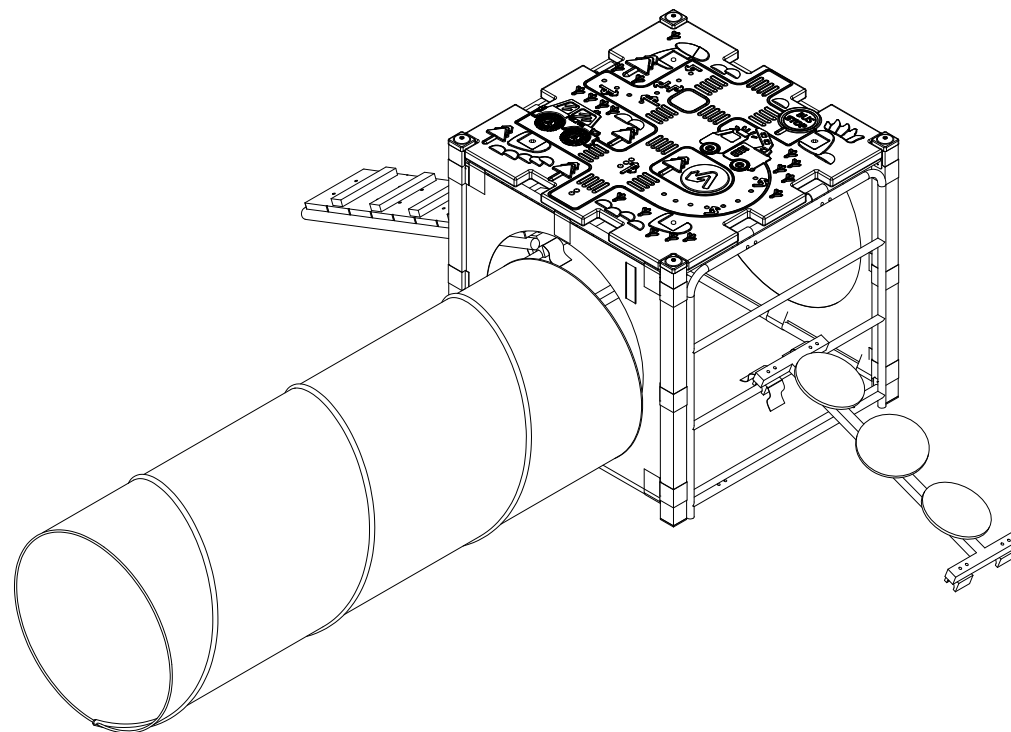

**Overall Dimensions: 265.7x250.7x84.4cm**  
**NW: 36.8KG**  
**GW: 45.2KG**

**Max component is Cube Frame**  
**Cube Frame dimensions: 86x86x84.4cm**  
**Cube Frame weight: 7KG**

# Activity Centres - Item Code: AJZH1A04

## Safety Range

Ensure the area is safe and devoid of any hazards prior to assembly.

Safety range of product: 5657x5507mm.

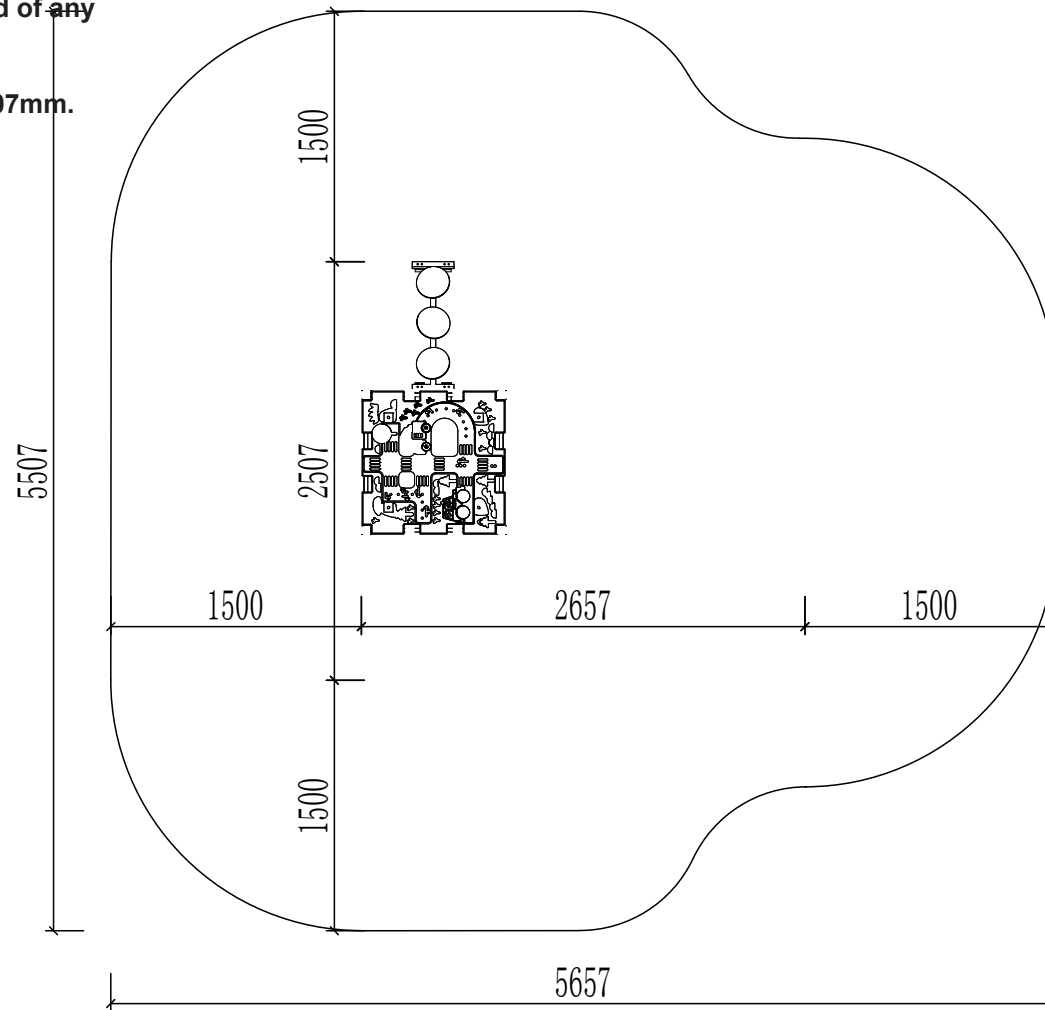

# Activity Centres - Item Code: AJZH1A04

## Part List

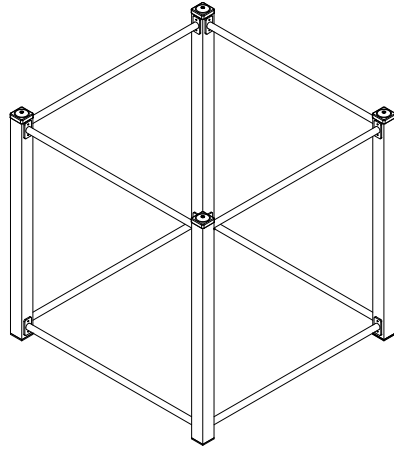

AJ1A2201-B\*1

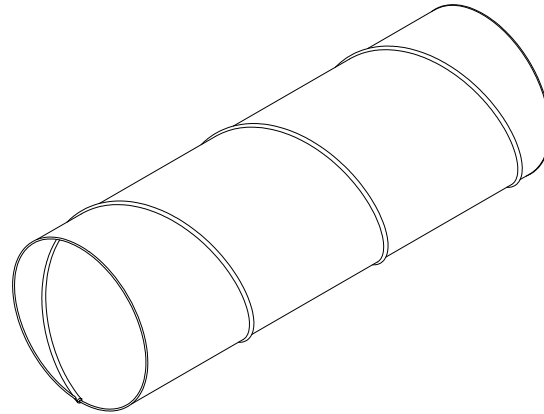

CW7-3YD2019\*1

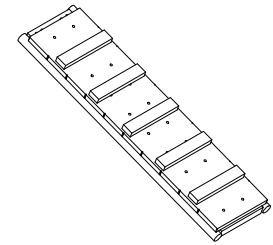

YJ001301\*1

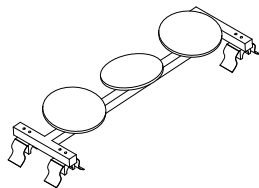

YJ001305-V01\*1

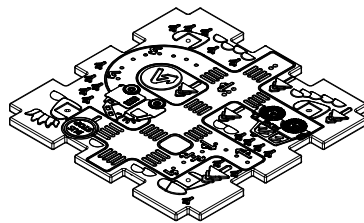

AJ1A2201-QB01-10-B\*1

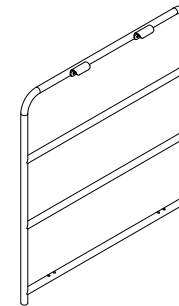

AJ1A2201-QB06\*2

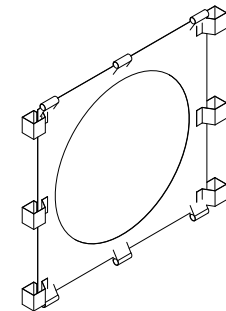

AJ1A2201-QB03\*2

# Activity Centres - Item Code: AJZH1A04

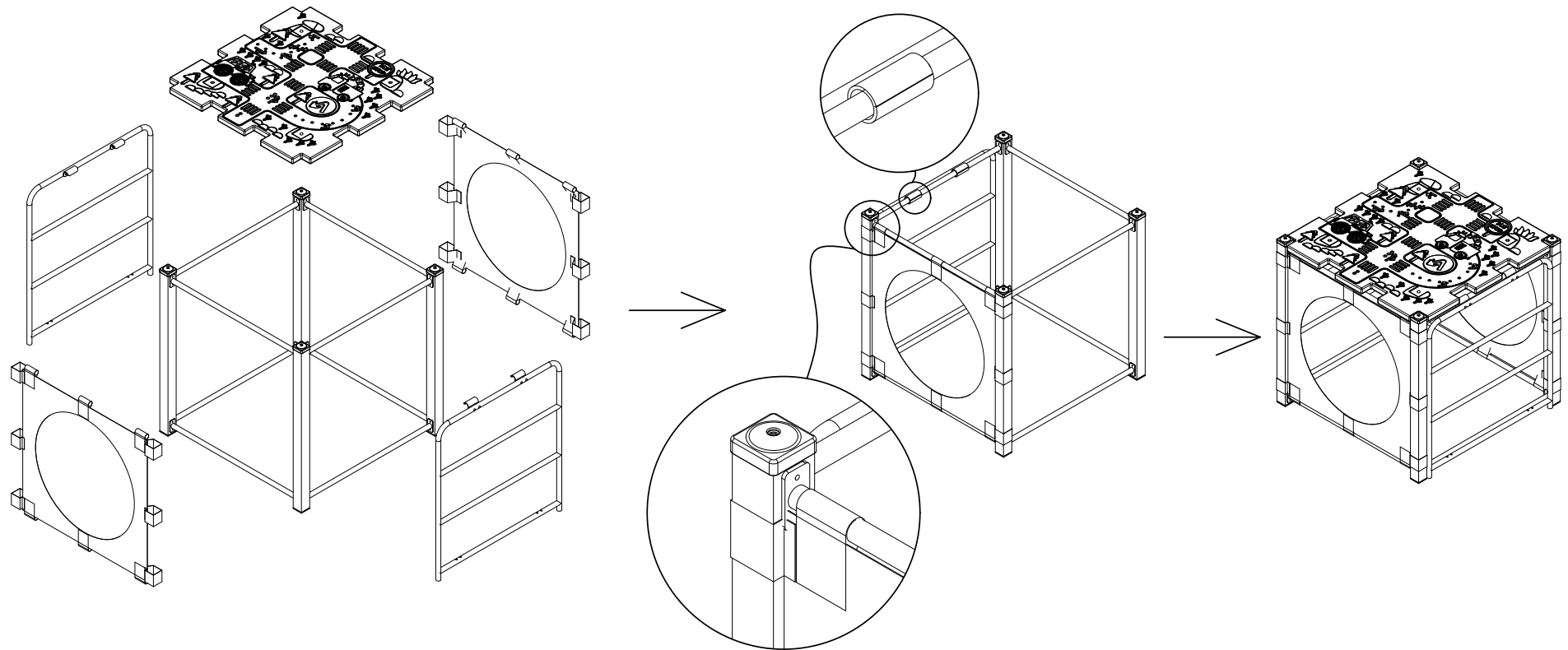

# Activity Centres - Item Code: AJZH1A04

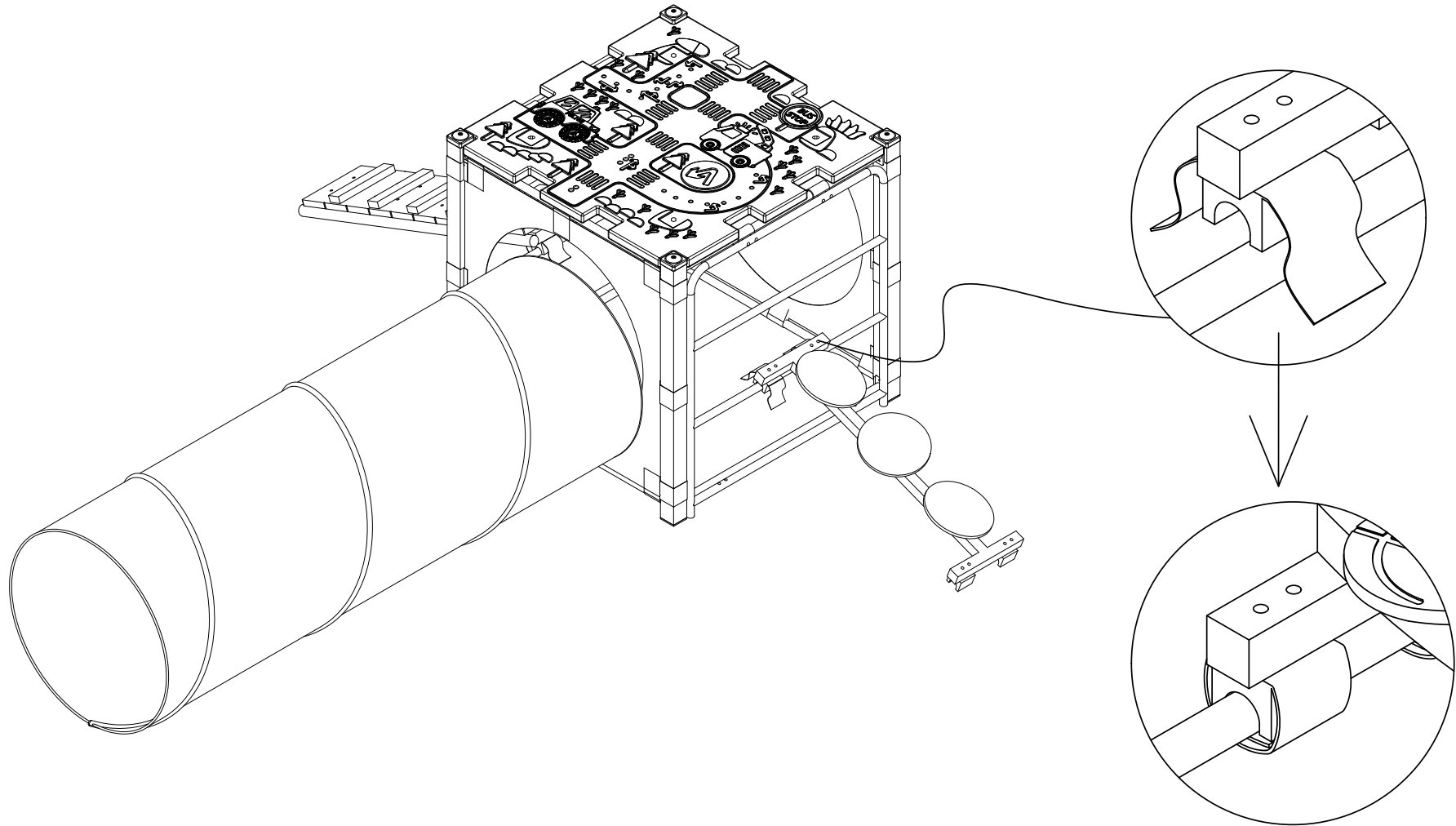

## Activity Centres - Item Code: AJZH1A04

INSPECTION INFORMATION				
Inspection cycle	Inspection Project	YES/NO	Solution	Signature
<b>Daily Inspection on Items</b>	Check screws, bolts and fasteners are tightened.			
	Installed on a flat surface and no hazards are present.			
	Equipment is free of dirt and moisture.			
	Hook and loop attachments are securely fastened.			
	Check for a signs of damage and wear.			
<b>Monthly Inspection on Items (Except for Daily Inspection on Items)</b>	Check screws are free of rust and damage.			
	Check parts are securely connected.			
	Check compliance labels are intact.			
	Check if the protective surfacing meet safety standards			
<b>Annual Inspection on Items (Except for Daily and Monthly Inspection on Items)</b>	Check there is no extensive corrosion and replace if required.			
	Check for cracking or connecting part deterioration. Replace if required.			
	Check there is no excessive discolouration of components.			
	Check screws and connectors are in working order and not damaged or deteriorated.			
	Check compliance labels are legible.			
	Check the play area under the equipment is safe and level.			

# Activity Centres - Item Code: AJZH1A05

**FRONT**

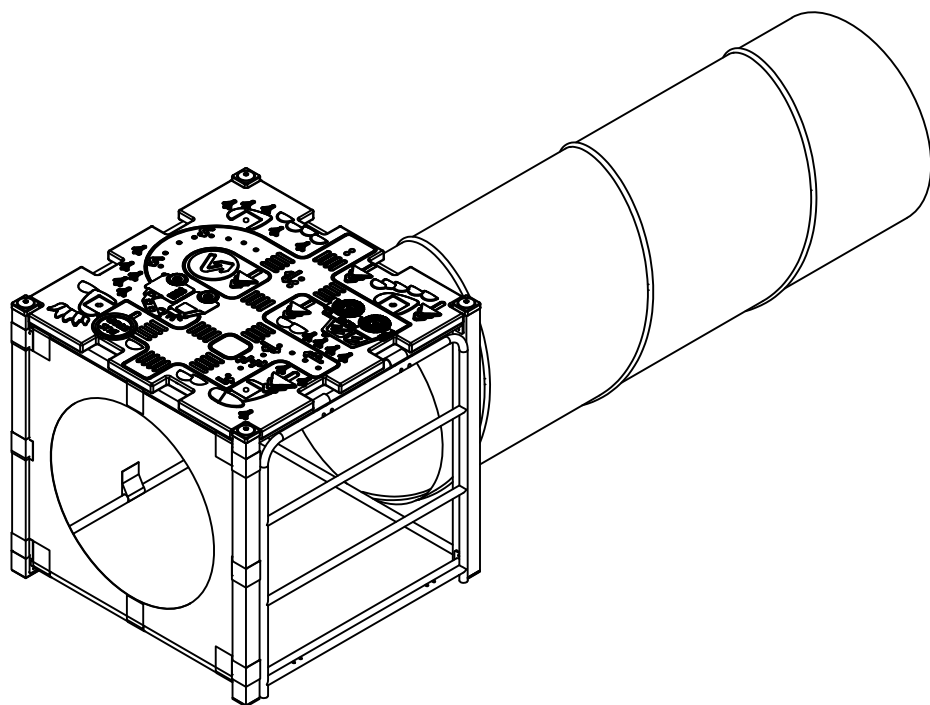

**BACK**

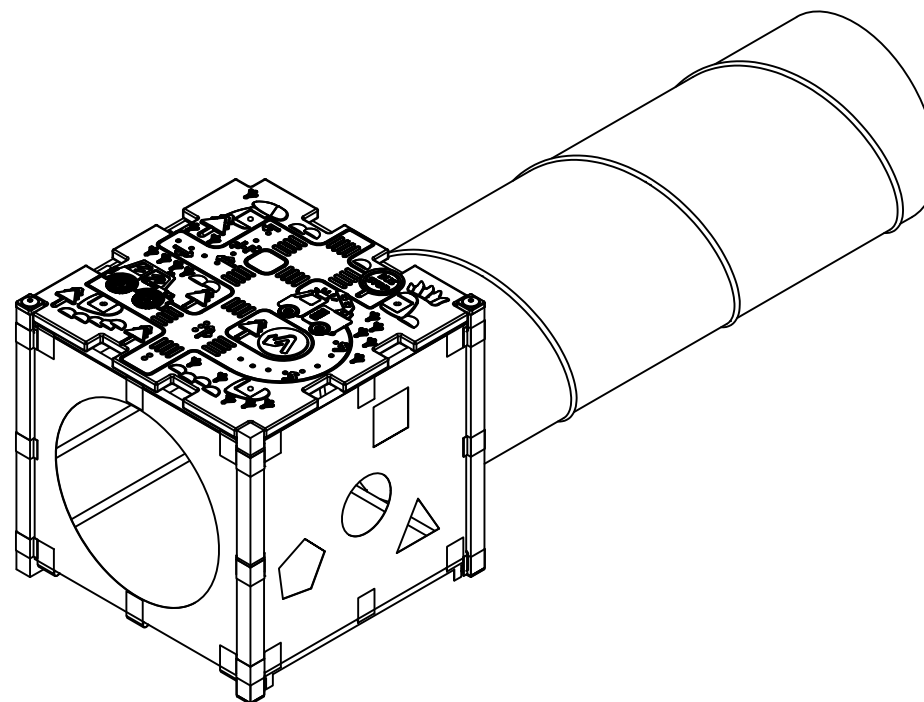

**Overall Dimensions: 265.7x250.7x84.4cm**  
**NW: 19.4KG**  
**GW: 24.6KG**

**Max component is Cube Frame**  
**Cube Frame dimensions: 86x86x84.4cm**  
**Cube Frame weight: 7KG**

# Activity Centres - Item Code: AJZH1A05

## Safety Range

Ensure the area is safe and devoid of any hazards prior to assembly.

Safety range of product: 7449x3885mm.

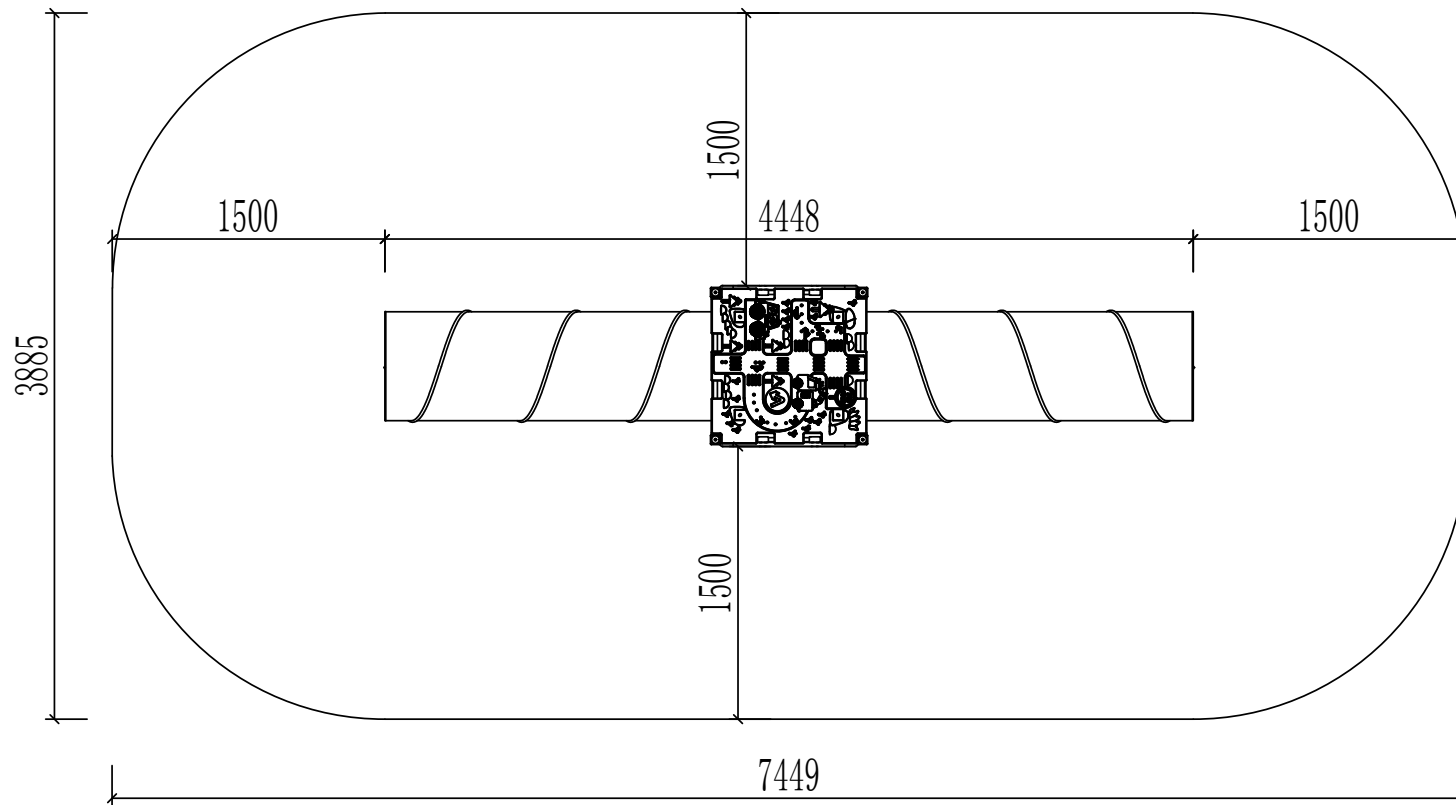



# Activity Centres - Item Code: AJZH1A05

## Parts List

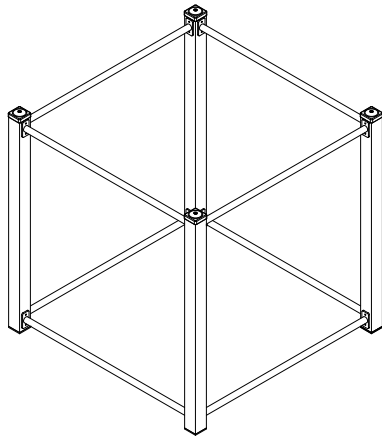

AJ1A2201-B\*1

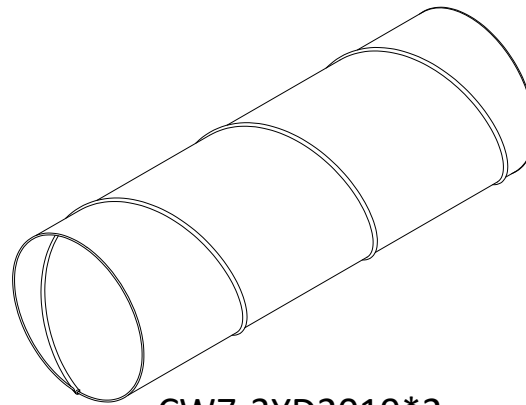

CW7-3YD2019\*2



D10-3YD2011\*24

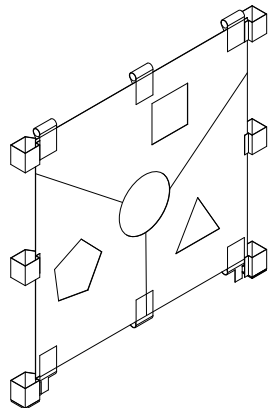

AJ1A2201-QB05\*1

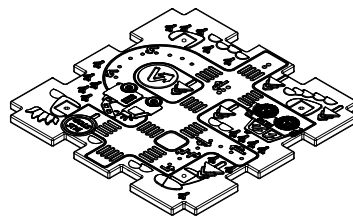

AJ1A2201-QB01-10-B\*1

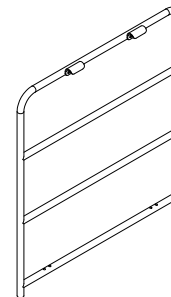

AJ1A2201-QB06\*1

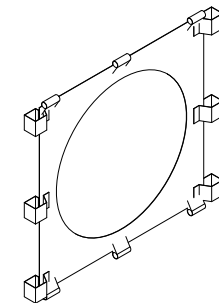

AJ1A2201-QB03\*2

# Activity Centres - Item Code: AJZH1A05

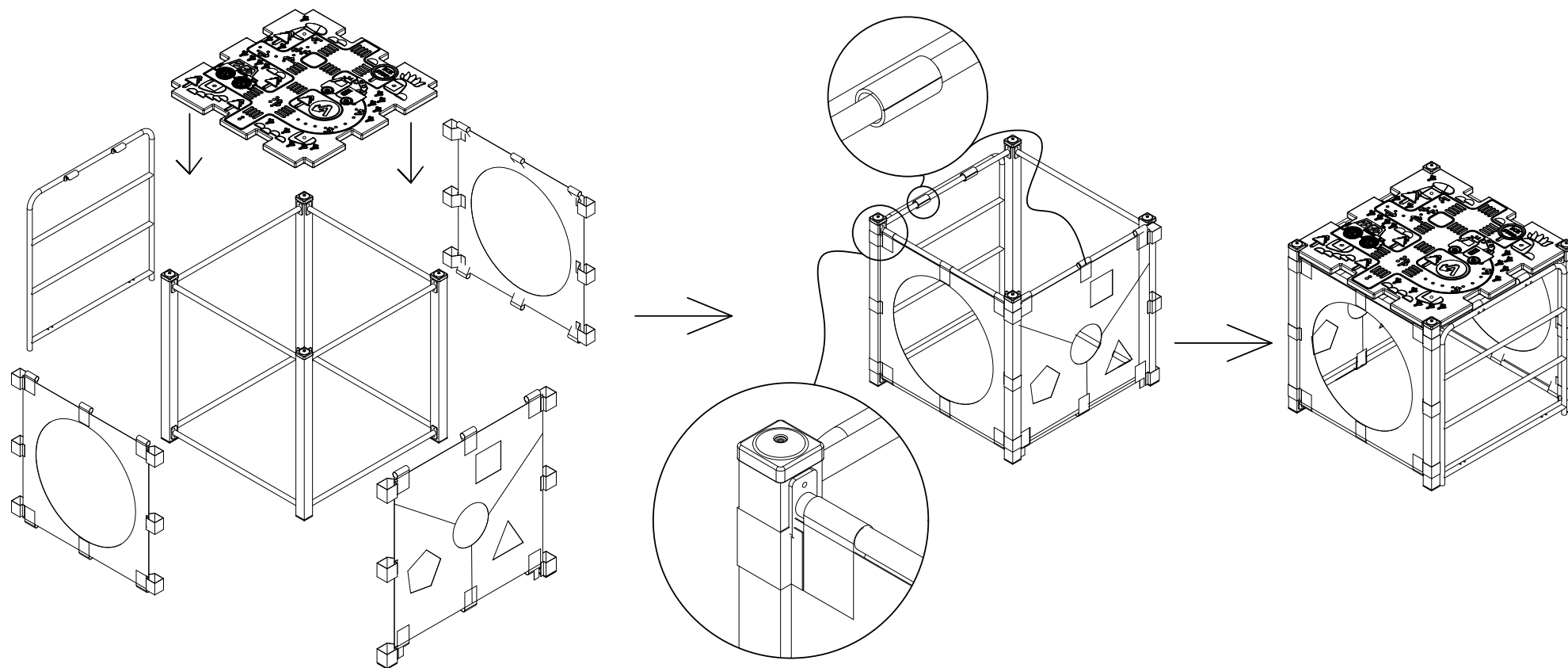

## Activity Centres - Item Code: AJZH1A05

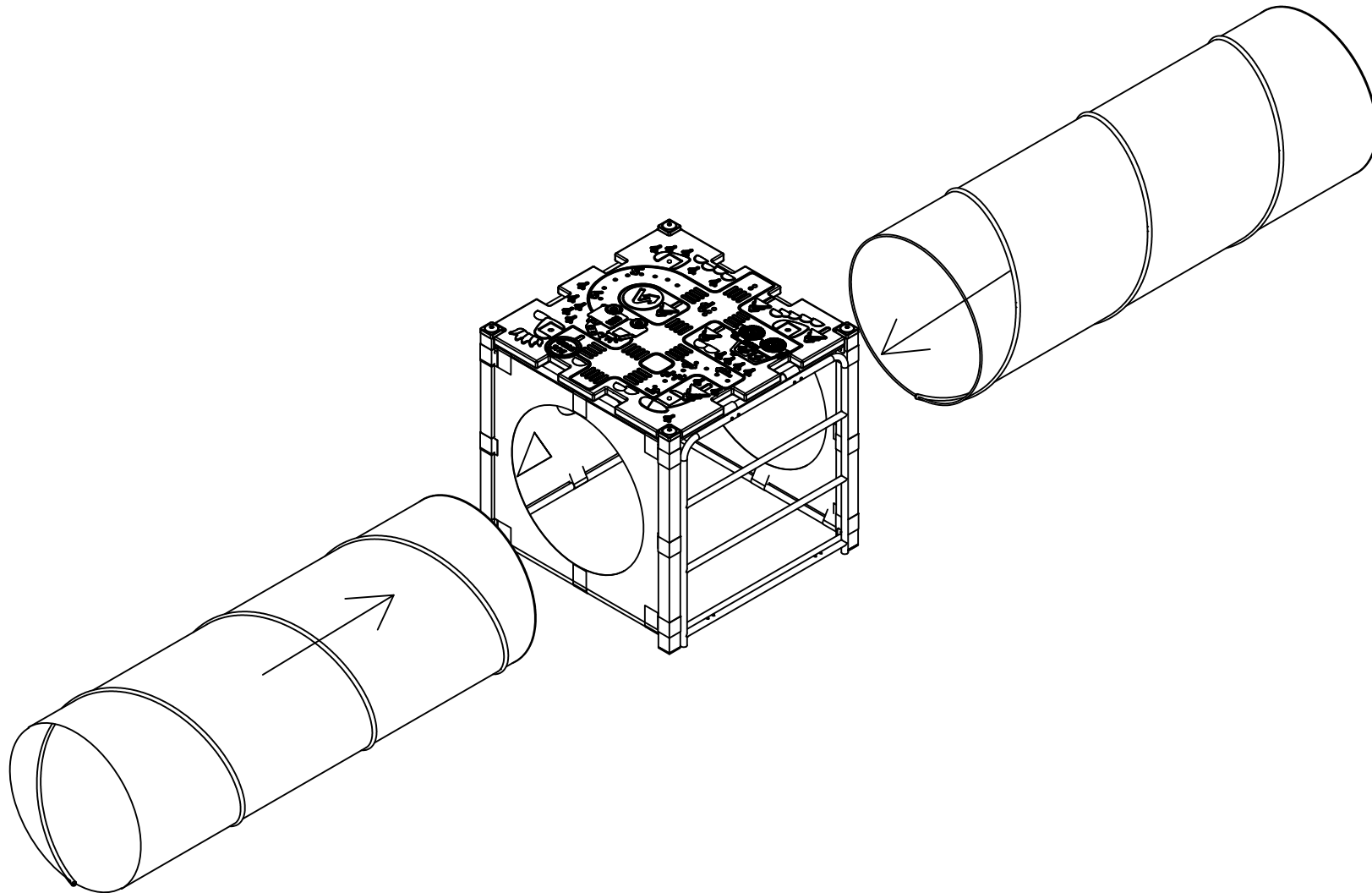

## Activity Centres - Item Code: AJZH1A05

INSPECTION INFORMATION				
Inspection cycle	Inspection Project	YES/NO	Solution	Signature
<b>Daily Inspection on Items</b>	Check screws, bolts and fasteners are tightened.			
	Installed on a flat surface and no hazards are present.			
	Equipment is free of dirt and moisture.			
	Hook and loop attachments are securely fastened.			
	Check for a signs of damage and wear.			
<b>Monthly Inspection on Items (Except for Daily Inspection on Items)</b>	Check screws are free of rust and damage.			
	Check parts are securely connected.			
	Check compliance labels are intact.			
	Check if the protective surfacing meet safety standards			
<b>Annual Inspection on Items (Except for Daily and Monthly Inspection on Items)</b>	Check there is no extensive corrosion and replace if required.			
	Check for cracking or connecting part deterioration. Replace if required.			
	Check there is no excessive discolouration of components.			
	Check screws and connectors are in working order and not damaged or deteriorated.			
	Check compliance labels are legible.			
	Check the play area under the equipment is safe and level.			